

## NO. S 1-10 "HIT" WIRE ROPE CUTTER



Notched shear-cut blades hold and lock wire in cutting position and gives clean, sharp cut. Designed for cutting wire rope, piano wire, steel wire, ACSR cable and aircraft cable.

Item No.	Length (mm)	Capacity (mm)	Wt (kg)	Packing (pcs/box)
001-10-WC06	350	6	0.8	1
001-10-WC10	600	10	2.3	1
001-10-WC14	750	14	3.85	1
001-10-WC16	900	16	5.5	1
001-10-WC20	1050	20	8.5	1
001-10-WCC10	Spare Jaws for WC10			
001-10-WCC14	Spare Jaws for WC14			
001-10-WCC16	Spare Jaws for WC16			
001-10-WCC20	Spare Jaws for WC20			



## NO. S 1-11 "HIT" WIRE ROPE CUTTER

Designed for cutting wire without crushing and deformation.

HWC-6

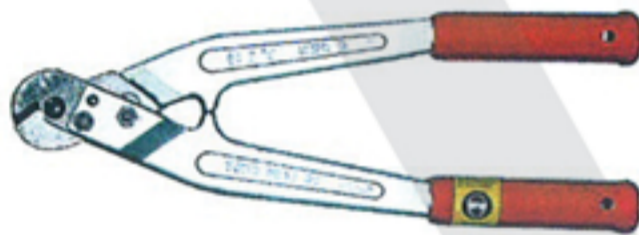

HWC-9



HWC-12, 16

Item No.	Length (mm)	Cutting Capacity				Wt (g)	Packing (pcs/box)
		Wire Rope Ø(mm)	Piano Wire Ø(mm)	Steel Wire Ø(mm)	ACSR Cable (mm <sup>2</sup> )		
001-11-HWC06	190	6	2.5	4	-	350	6
001-11-HWC09	335	9	4.0	6	25	710	1
001-11-HWC12	520	12	4.5	7	58	1500	1
001-11-HWC16	650	16	5.0	9	120	2500	1
001-11-HWCBN12	Bolts & Nuts for HWC12						
001-11-HWCBN16	Bolts & Nuts for HWC16						
001-11-HWCC09	Spare Jaws for HWC09						
001-11-HWCC12	Spare Jaws for HWC12						
001-11-HWCC16	Spare Jaws for HWC16						
001-11-HWCS06	Spring for HWC6						

## NO. S 1-12 "HIT" WIRE ROPE CUTTER

For cutting all soft or hard steel cable and wire rope.



W-16

Item No.	Length (mm)	Cutting Capacity			Wt (g)	Packing per box
		Copper/ Alum. (mm <sup>2</sup> )	Wire Rope Ø(mm)	ACSR Cable (mm <sup>2</sup> )		
001-12-W16	710	250	16	120	2200	1 pc
001-12-WBN16	Bolts & Nut for W-16					1 set

## NO. S 1-1 "HIT" STANDARD BOLT CUTTER (BLACK JAW)



Recommended for general use. Suitable for concrete reinforcing rods, medium tensile and soft bolts, rods, rivets, bars, chain, etc.  
 Max. permissible hardness : Brinell 370, Rockwell C40, 85 tons/sq. 133kg/mm<sup>2</sup>.

\* All HIT bolt cutters exceed U.S.A. Federal Specification No. GGG-C-740d Type II.

### (CLIPPER CUT)

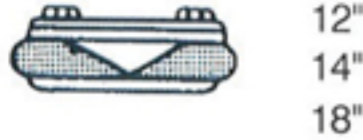

12"  
14"  
18"

### (CENTER CUT)



24"  
30"  
36"  
42"

### \* HEAD W/BOLTS & NUTS



Item No.	Length (mm)	Cutting Capacity		Wt (g)	Packing (pcs/box)
		49.6 kg/mm <sup>2</sup> Ø (mm)	HRC-40 133 kg/mm <sup>2</sup> Ø (mm)		
<b>Bolt Cutter</b>					
001-01-BC12	300 (12")	5	4	700	12
001-01-BC14	350 (14")	7	5	1000	12
001-01-BC18	450 (18")	8	6	1700	6
001-01-BC24	600 (24")	10	8	2800	6
001-01-BC30	750 (30")	13	9	4200	2
001-01-BC36	900 (36")	16	10	6400	2
001-01-BC42	1050 (42")	19	11	8600	1
<b>Spare Heads w/Bolts &amp; Nuts</b>					
001-01-BCC12	300 (12")	5	4	260	1
001-01-BCC14	350 (14")	7	5	450	1
001-01-BCC18	450 (18")	8	6	650	1
001-01-BCC24	600 (24")	10	8	1100	1
001-01-BCC30	750 (30")	13	9	1700	1
001-01-BCC36	900 (36")	16	10	2450	1
001-01-BCC42	1050 (42")	19	11	3250	1

## NO. S 1-2 "HIT" HIGH TENSILE STEEL CUTTER (RED JAW) FOR EXTRA HARD STEEL



High Tensile Jaws are specially heat-treated. Suitable for cutting very hard material. They have a short cutting edge to accommodate chain links, high tensile bolts, rods and high tensile wire for pre-stressed concrete, cold drawn alloy steel wire, tempered spring wire, case-hardened chains, etc. Maximum permissible hardness : Brinell 450, Rockwell C48, 110 tons/sq. 162kg/mm<sup>2</sup>.

### How to adjust cutting edge

This is the adjusting bolt (eccentric bolt) for cutting edge.

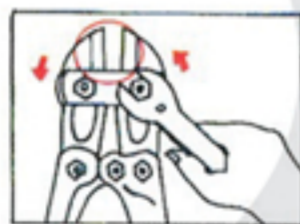

1. Loosen nuts on cam bolts about one round (360°)



2. Align cutter jaws by rotating the cam bolts; move arrows on cam bolt inward to close jaw.



3. Tighten nuts.

Item No.	Length (mm)	Cutting Capacity		Wt (g)	Packing (pcs/box)
		49.6 kg/mm <sup>2</sup> Ø (mm)	HRC-48 162 kg/mm <sup>2</sup> Ø (mm)		
<b>High Tensile Steel Cutter</b>					
001-02-BC12H	300 (12")	5	4	700	12
001-02-BC14H	350 (14")	7	5	1000	12
001-02-BC18H	450 (18")	8	5.5	1700	6
001-02-BC24H	600 (24")	10	7	2800	6
001-02-BC30H	750 (30")	13	8	4200	2
001-02-BC36H	900 (36")	16	9	6400	2
001-02-BC42H	1050 (42")	19	10	8600	1
<b>Spare Heads w/Bolts &amp; Nuts</b>					
001-02-BCC12H	300 (12")	5	4	260	1
001-02-BCC14H	350 (14")	7	5	450	1
001-02-BCC18H	450 (18")	8	5.5	650	1
001-02-BCC24H	600 (24")	10	7	1100	1
001-02-BCC30H	750 (30")	13	8	1700	1
001-02-BCC36H	900 (36")	16	9	2450	1
001-02-BCC42H	1050 (42")	19	10	3250	1



RC-13BN  
RC-16BN



RC-19B  
(With Extendible handle)

## NO. S 1-7 "HIT" ROD CUTTER

The most dependable ROD CUTTER has been designed to make efficient and light work of cutting concrete reinforcing rods, etc., for both the building and engineering trade alike.

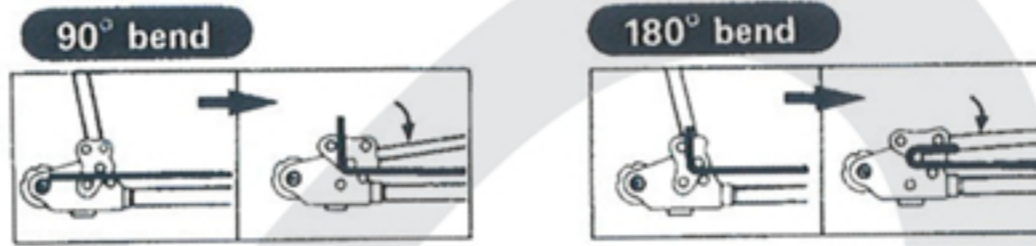

Item No.	Length (mm)	Cutting Capacity Ø (mm)	Wt (kg)	Packing per box
001-07-RC13BN	1070 (42")	13 (1/2")	10.5	1 pc
001-07-RC16BN	1320 (52")	16 (5/8")	14.0	1 pc
001-07-RC19B	1320-2032 (52" - 80")	19 (3/4")	26.0	1 pc
001-07-RCBN13BN	Bolts & Nuts for RC13BN			1 set
001-07-RCBN16BN	Bolts & Nuts for RC16BN			1 set
001-07-RCBN19B	Bolts & Nuts for RC19B			1 set
001-07-RCC13BN	Spare Jaws w/bolts & nuts for RC13BN			1 pc
001-07-RCC16BN	Spare Jaws w/bolts & nuts for RC16BN			1 pc
001-07-RCC19B	Spare Jaws w/bolts & nuts for RC19B			1 pc



TRCW8-10

## NO. S 1-8 "HIT" THREAD ROD CUTTER WITH DOUBLE DIES

Used primarily on construction sites where threaded rod is used to secure pipe, conduit, sprinkler systems, duct work, lighting, ceiling and many other construction components.

Item No.	Length (mm)	Capacity Dia. x Pitch	Wt (kg)	Packing per box
001-08-TRCW0810	740	8mm x 1.25mm 10mm x 1.5mm	4.1	1 pc
001-08X-TRCC06	Spare Die 6.0mm for thread rod cutter			2 pcs
001-08X-TRCC10	Spare Die 10.0mm for thread rod cutter			2 pcs
001-08X-TRCCF10	Spare Die 3/8" (TRCC3/8) for thread rod cutter			2 pcs

## NO. S 1-9 "HIT" POCKET CUTTER SERIES

Special alloy hardened and tempered cutter blade. Lightweight, comfortable grip and spring action.



PA-200 Pocket Angular Cutter



PC-200 Pocket Cutter



PE-200 Pocket End Cutter



PH-200 Pocket Cutter For Piano Wire

Item No.	Max. Cutting Capacity			Wt (g)	Packing (pcs/box)
	Mild Steel HRC Brinell 140 Ø (mm)	Hard Steel HRC 40 Brinell 370 Ø (mm)	Music Wire HRC 44 Brinell 410 Ø (mm)		
001-09-PA	3.5	2	-	280	6
001-09-PC	4	2	-	280	6
001-09-PE	3.5	2	-	260	6
001-09-PH	4	3	2.5	270	6

## NO. S 1-3 "HIT" ANGULAR CUTTER

Flush cutting for wires in concrete walls, ceilings, floor etc.



Item No.	Length (mm)	Cutting Capacity		Wt (g)	Packing (pcs/box)	Price (pc)
		49.6 kg/mm <sup>2</sup> Ø (mm)	HRC-40 133 kg/mm <sup>2</sup> Ø (mm)			
001-03-AC350	350 (14")	7	5	1000	6	
001-03-AC450	450 (18")	8	6	1700	6	
001-03-AC600	600 (24")	10	7	2800	6	
001-03-ACC350	Spare Jaws w/bolts & nuts for AC350					
001-03-ACC450	Spare Jaws w/bolts & nuts for AC450					
001-03-ACC600	Spare Jaws w/bolts & nuts for AC600					

## NO. S 1-4 "HIT" BOLT CUTTER WITH INSULATED FIBERGLASS HANDLE

This new insulated fiberglass handle bolt cutter is specially made for electric and construction work.

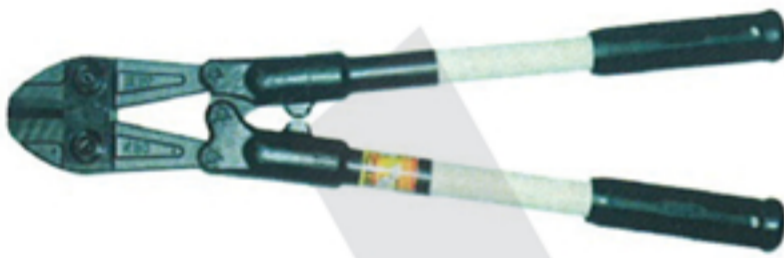

Item No.	Length (mm)	Cutting Capacity		Wt (g)	Packing (pcs/box)	Price (pc)
		49.6 kg/mm <sup>2</sup> Ø (mm)	HRC-40 133 kg/mm <sup>2</sup> Ø (mm)			
001-04-BC18F	450 (18")	8	6	1500	6	
001-04-BC24F	600 (24")	10	8	2700	6	

## NO. S 1-6 "HIT" ROD MESH CUTTER

Specially designed for cutting concrete wire mesh (netting).



Item No.	Length (mm)	Cutting Capacity		Wt (g)	Packing (pcs/box)	Price (pc)
		49.6 kg/mm <sup>2</sup> Ø (mm)	HRC-40 133 kg/mm <sup>2</sup> Ø (mm)			
001-06-RCA800	800	9	8	3150	2	
001-06-RCAC800	Spare jaws w/bolts & nuts for RCA-800					

## NO. S 1-25 "HIT" PIPE WRENCH WITH ALL DROP-FORGED STEEL HANDLE



HIT U-type all drop-forged steel heavy duty pipe wrench. Won't break or warp. Meet Japan Industrial Standard JIS B 4606 PER No. 657. Exceed USA Federal Specification No. GGG-W-651c, Type II Class A Heavy duty.

Item No.	Length (mm)	Capacity (mm)	Wt (g)	Packing (pcs/box)
001-25-PU0150	150 (6")	27	220	12
001-25-PU0200	200 (8")	34	360	12
001-25-PU0250	250 (10")	42	680	6
001-25-PU0300	300 (12")	48	1030	6
001-25-PU0350	350 (14")	60	1430	6
001-25-PU0450	450 (18")	76	2330	6
001-25-PU0600	600 (24")	89	3580	6
001-25-PU0900	900 (36")	114	6600	2
001-25-PU1200	1200 (48")	140	10700	1

## NO. S 1-26 "HIT" PIPE WRENCH WITH ALL DROP-FORGED ALUMINIUM ALLOY BODY



HIT U-frame heavy-duty wrenches are the strongest available tools of this type. Handle and full floating hook jaws are made of drop-forged special aluminium alloy and almost 50% lighter than steel or malleable handle pipe wrenches.

Item No.	Length (mm)	Capacity (mm)	Wt (g)	Packing (pcs/box)
001-26-ALP300	300 (12")	48	570	6
001-26-ALP350	350 (14")	60	800	6
001-26-ALP450	450 (18")	76	1230	6
001-26-ALP600	600 (24")	89	1840	6
001-26-ALP900	900 (36")	114	3400	1

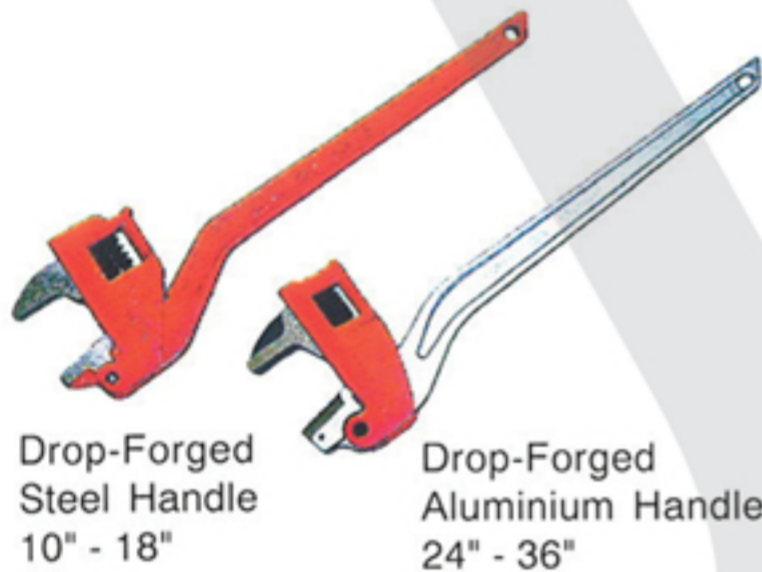

Drop-Forged Steel Handle  
10" - 18"

Drop-Forged Aluminium Handle  
24" - 36"

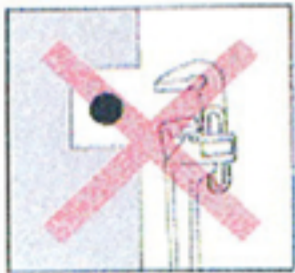

## NO. S 1-27 "HIT" MULTI-PURPOSE WRENCH

Newly designed pipe wrench for multi-purpose use. Easy action on narrow spaces and corners. Size 10" to 18" made of forged steel body and sizes 24" & 36" made of forged aluminium body for less weight.

Item No.	Length (mm)	Capacity (mm)	Wt (g)	Packing (pcs/box)
001-27-CPW250	250	8 ~ 25	600	6
001-27-CPW300	300	10 ~ 32	900	6
001-27-CPW350	350	15 ~ 40	1200	6
001-27-CPW450	450	25 ~ 50	1900	6
001-27-CPW600	600	40 ~ 80	2700	4
001-27-CPW900	900	65 ~ 100	4900	2

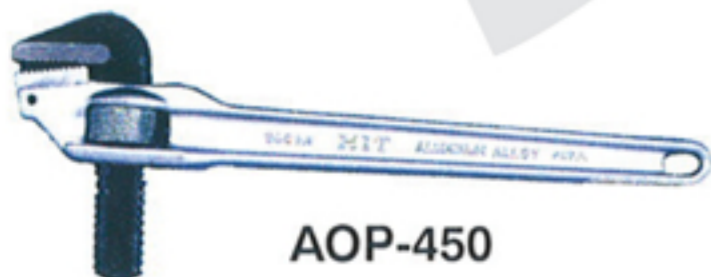

AOP-450

## NO. S 1-28 "HIT" OFFSET WRENCH WITH ALUMINIUM HANDLE

Drop forged aluminium alloy body and steel hook and heel jaws.

Item No.	Length (mm)	Capacity (mm)	Wt (g)	Packing (pcs/box)
001-28-AOP450	450 (18")	76	1200	2



**NO. S 1-22 "HIT" CHAIN WRENCH**

All drop-forged, heavy-duty pipe wrench with safety chain stopper. Suitable for use on round, hexagon, square and irregular shape objects and in awkward corners.



Item No.	Handle Lgth (mm)	Chain L (mm)	Capacity (mm)	Wt (g)	Packing (pcs/box)
001-22-CW03	290	438	14-89	1100	6
001-22-CW03L	290	663	14-165	1700	6
001-22-CW04	390	512	17-114	1250	6
001-22-CW06	490	686	27-165	3000	2
001-22-CW08	670	857	34-216	5500	1
001-22-CW10	710	980	34-267	6400	1
001-22-CW10L	710	1170	34-320	6450	1

**SPARE CHAIN**

Item No.	Chain L (mm)	Capacity (mm)	Packing (pcs/box)
001-22-CWC03	438	14-89	1
001-22-CWC04	512	17-114	1
001-22-CWC06	686	27-165	1
001-22-CWC08	857	34-216	1
001-22-CWC10	980	34-267	1
001-22-CWC10L	1170	34-320	1

**NO. S 1-23 "HIT" FLANGE WRENCH**

Forged strong I-Beam handle, designed for working on any suitable type of flange as well as regular pipe. Excellent for flange fittings.



FCW-6

Item No.	Handle Lgth (mm)	Chain L (mm)	Capacity (mm)	Wt (g)	Packing (pcs/box)
001-23-FCW6	490	990	280	3730	1

**NO. S 1-24 "HIT" BELT (STRAP) WRENCH**

Special fabric belt that tightens pipes without leaving marks.



BTW-3G (Rubber-Impregnated)  
BTW-6G (Rubber-Impregnated)



BTW-3  
BTW-6  
BTW-14

Item No.	Handle Lgth(mm)	Capacity (mm)	Belt Lgth (mm)	Belt Width (mm)	Wt (g)	Packing (pcs/box)
001-24-BTW03	300 (12")	15- 75	400	30	570	1
001-24-BTW03G	300 (12")	15- 75	400	30	600	1
001-24-BTW06	300 (12")	15-165	700	30	590	1
001-24-BTW06G	300 (12")	17-165	700	30	650	1
001-24-BTW14	300 (12")	15-250	1400	30	710	1
001-24-BTWB06	Spare Belt for BTW6					1
001-24-BTWB14	Spare Belt for BTW14					1

**NO. S 1-13 "HIT" CABLE CUTTER**



SC-30

For cutting soft, non-steel, copper & aluminium cable. Do not use on ACSR cable.

Item No.	Length (mm)	Max. Cutting Capacity		Wt (g)	Packing (pcs/Box)
		Copper IV Cable 38 mm <sup>2</sup>	Copper WCT Cable 90 mm <sup>2</sup>		
001-13-SC030	240	11.5mmØ	24.0mmØ	480	6

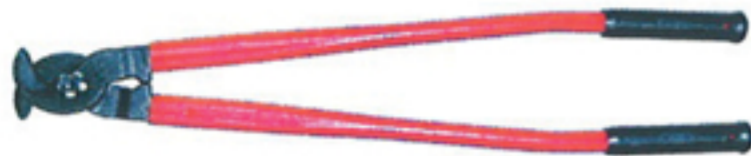

SC-250

Item No.	Length (mm)	Max. Cutting Capacity			Wt (g)	Packing per box
		Alum. Cable (mm <sup>2</sup> )	Copper Cable (mm <sup>2</sup> )	Ø (mm)		
001-13-SC250	600	250	250	26	1700	1 pc
001-13-SC250R	600	350	250	33	1780	1 pc
001-13-SC500R	830	650	300	50	3900	1 pc
001-13-SCBN250R	Bolt & Nut for SC-250 & SC-250R					1 set
001-13-SCBN500R	Bolt & Nut for SC-500R					1 set
001-13-SCC250R	Spare Jaws with bolts & nuts for SC-250R					1 pc
001-13-SCC500R	Spare Jaws with bolts & nuts for SC-500R					1 pc

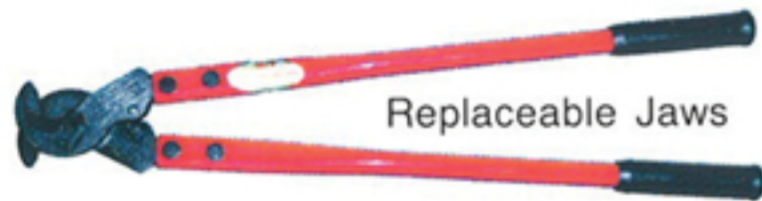

Replaceable Jaws

SC-250R SC-500R

**NO. S 1-14 "HIT" CABLE CUTTER WITH INSULATED FIBREGLASS HANDLE**



SCF-250

Insulated Fiberglass Handle

For cutting soft, non-steel, copper & aluminium cable. Fibreglass handle is specially made for electric work. Do not use on ACSR cable.

Item No.	Length (mm)	Max. Cutting Capacity			Wt (g)	Packing (pcs/box)
		Alum. Cable (mm <sup>2</sup> )	Copper Cable (mm <sup>2</sup> )	Ø (mm)		
001-14-SCF250	650	350	250	33	1780	1
	Spare Jaws for SCF250 (same as SC-250R)					

**NO. S 1-15 " HIT" NEW CABLE CUTTER**



CC-20 CC-30 CC-50

For cutting soft, non-steel, copper & aluminium cable. Do not use on ACSR cable.

Item No.	Length (mm)	Max. Cutting Capacity			Wt (g)	Packing (pcs/box)
		Alum. Cable (mm <sup>2</sup> )	Copper Cable (mm <sup>2</sup> )	Ø (mm)		
001-15-CC20	450	150	150	20	1400	1
001-15-CC30	760	325	325	30	3500	1
001-15-CC50	1050	500	500	50	8500	1
001-15-CCC20	Spare Jaws for CC-20					1
001-15-CCC30	Spare Jaws for CC-30					1
001-15-CCC50	Spare Jaws for CC-50					1

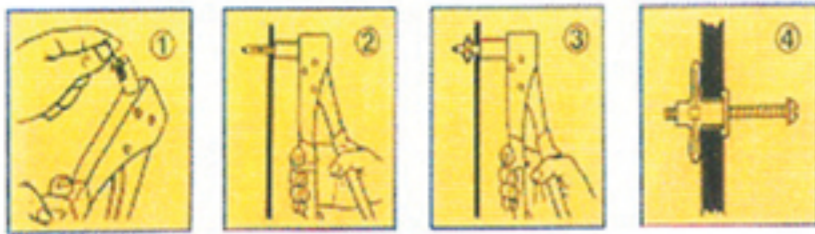

## NO. S 1-45 "HIT" STEEL BOARD ANCHOR STANDARD TYPE

Ideal for use in all kinds of hard or soft proprietary wall boards, plaster and asbestos, hollow bricks, tiles, etc.

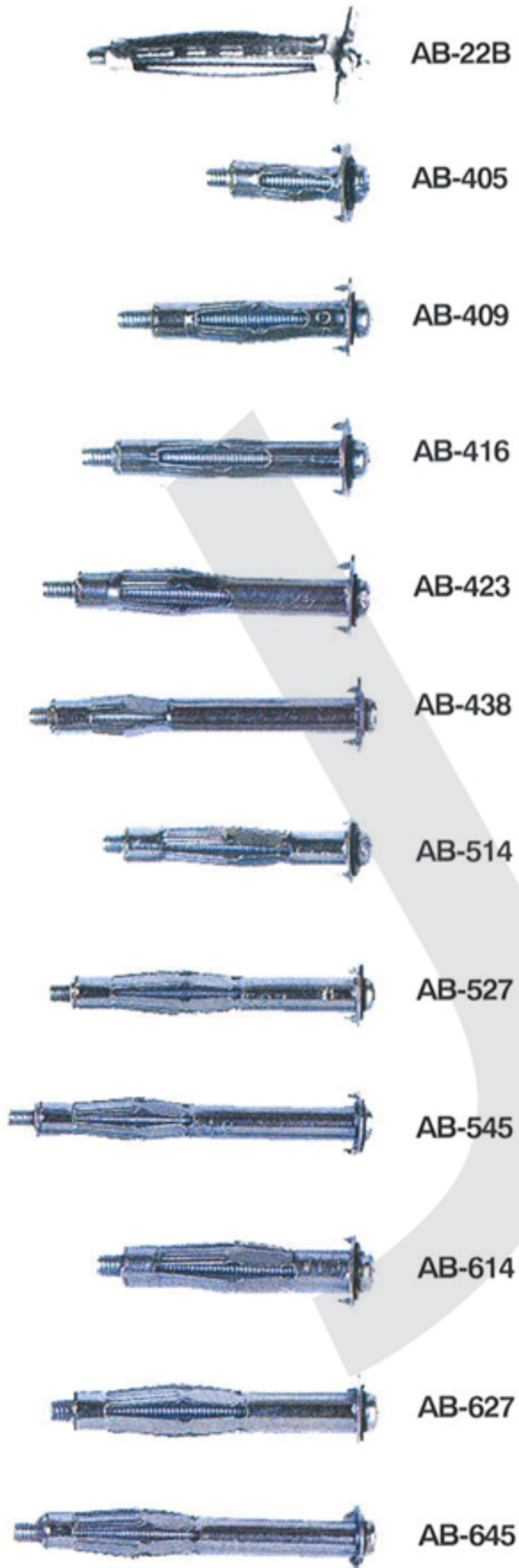

Item No	Screw Dia. (mm)	Screw Length (mm)	Board Thickness (mm)	Drill Hole Dia. (mm)	Packing (pcs)
001-45-AB22B	4	50	9 ~ 22	9	100/box
001-45-AB405	4	20	1 ~ 5	9	50/box
001-45-AB409	4	33	3 ~ 9.5	9	50/box
001-45-AB416	4	39	9 ~ 16	9	50/box
001-45-AB423	4	46	16 ~ 23	9	50/box
001-45-AB438	4	60	32 ~ 38	9	50/box
001-45-AB514	5	52	3 ~ 14	11	50/box
001-45-AB527	5	65	14 ~ 30	11	50/box
001-45-AB545	5	80	32 ~ 43	11	50/box
001-45-AB614	6	53	6 ~ 14	13	50/box
001-45-AB627	6	65	14 ~ 30	13	50/box
001-45-AB645	6	80	32 ~ 43	13	50/box



## NO. S 1-16 "HIT" SWAGING TOOL

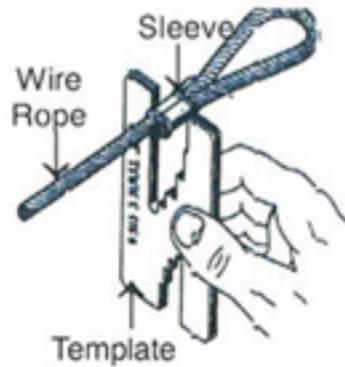

Multi-compression hand swager with or without cable cutters.  
Durable jaws are made from forged alloy steel with special heat treated and hardened.

Item No.	Model No.	Wire Rope Dia. For Swagging & Cutting	Cutting Capacity	Lgth (mm)
001-16-CT350	CT350/3	1/16", 3/32", 1/8"	w/o cutter	350
001-16-CT350C	CT350/3C	1/16", 3/32", 1/8"	1/8"	350
001-16-CT600	CT600/5	1/16", 3/32", 1/8", 5/32", 3/16"	w/o cutter	600
001-16-CT600C	CT600/5C	1/16", 3/32", 1/8", 5/32", 3/16"	1/4"	600
001-16-CT750	CT750/3	5/32", 1/4", 5/16"	w/o cutter	750
001-16-CT750C	CT750/3C	5/32", 1/4", 5/16"	5/16"	750
001-16-CT900	CT900	3/8"	w/o cutter	900

Packing : 1 pc per box

## NO. S 1-17 "HIT" RATCHET CABLE CUTTER

With a gear transmission mechanism, the cable cutter requires less force for cutting cable and even CV Wires up to 42mm diameter. Do not use on hard copper, ACSR, steel & piano wire.



CCR 500

Item No.	Length (mm)	Ø (mm)	Cutting Capacity		
			Kind of Cable	Wt (g)	Packing (pcs/box)
001-17-CCR500	185	42	IV Wire Single Core 500mm <sup>2</sup> CV Wire 3-Core 100mm <sup>2</sup> CV Wire Single Core 500mm <sup>2</sup>	1200	1
001-17-CCRC5001	Spare Fix Blade				1
001-17-CCRC5002	Spare Movable Blade				1
001-17-CCRW04	Spare Medium Gear Wheel #4				1
001-17-CCRW06	Spare Small Gear Wheel #6				1

## NO. S 1-18 "HIT" HEAVY DUTY STEEL STRAP CUTTER

Excellent for pallets, loading and unloading freight cars, trucks and machines.



SS200



SS450



↑  
Bolt & nut

SS600

Item No.	Length (mm)	Steel Strap (mm)	Wt (kg)	Packing (pcs/box)
001-18-SS200	240	32 x 0.9	0.3	6
001-18-SS450	450	50 x 1.2	1.4	1
001-18-SS600	600	50 x 1.3	2.7	1
001-18-SSBN600	Spare bolt & nut for SS-600			

**NO. S 1-19 "HIT" ADJUSTABLE WRENCH**



**CHROME FINISH**

All HIT Adjustable Wrenches exceed JAPAN JIS Standard and U.S.A. Federal Specification No GGG-W-631b, Type I Heavy-Duty. Made of all drop-forged steel, with chrome plated finish.

Item No.	Length (mm)	Capacity (mm)	Wt (g)	Packing (pcs/box)
001-19-SM100	100 ( 4")	14	46	6
001-19-SM150	150 ( 6")	21	110	6
001-19-SM200	200 ( 8")	25	230	6
001-19-SM250	250 (10")	30	390	6
001-19-SM300	300 (12")	35	590	6
001-19-SM375	375 (15")	45	1280	1
001-19-SM450	450 (18")	55	2150	1

**NO. S 1-20 "HIT" ADJUSTABLE SPUD WRENCH**

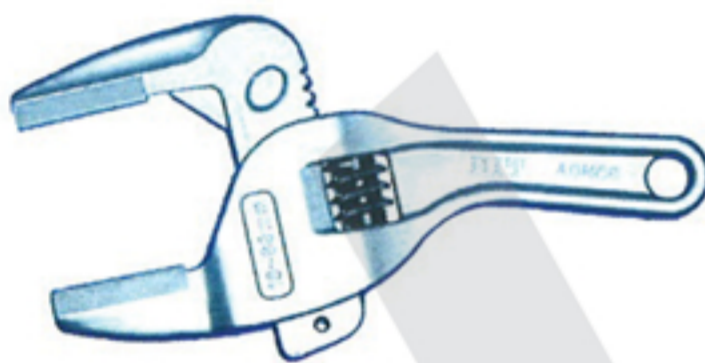

Die casting Aluminium Alloy Construction. Weigh only 240g, a perfect tool for working in the tightest quarters to be reached by one hand. Jaws can be opened up to 2-11/16" (68mm) to reach difficult areas. Durable soft jaw pads protect work from marring. Best suited for polished, chrome plated, brass tubular and fittings against scratch damage or deform. Excellent for working on plumbing, water filters, PVC conduits and polished shafts.

Item No.	Length (mm)	Capacity (mm)	Wt (g)	Packing (pcs/box)
001-20-AOM68	200	16 - 68	240	6

**NO. S 1-21 "HIT" HOSE CUTTER**



**HC-500**

Designed to cut reinforced rubber hose by thin steel wire, for application indoor City GAS Line/ Lubrication Rubber Hose etc.

Item No.	Length (mm)	Max. Cutting Capacity	Wt (kg)	Packing (pcs/box)
001-21-HC500	500	Hard Gas Hose 9.5, 13, 19, 25mm	1.8	1



### NO. S 1-41 "HIT" PLUG BOLT PLIER

This heavy-duty type plier is ideal for anchor and plug bolts with max. 6mm diameter.

Item No.	Length (mm)	Wt. (g)	Packing (pcs/box)
001-41-AB100	235	510	6



### NO. S 1-42 "HIT" PLUG BOLT

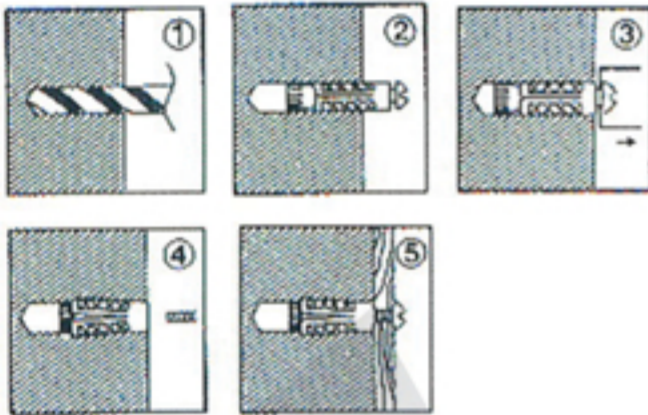

Item No.	Bolt Dia. (mm)	Body		Drill Dia. (mm)	Packing (pcs/box)
		Dia. (mm)	Length (mm)		
001-42-PB000	3	6	15.0	6.4	100
001-42-PB100	4	7	17.5	7.5	100
001-42-PB200	5	8	20.5	8.5	50



### NO. S 1-43 "HIT" HOLLOW WALL ANCHOR ALUMINIUM TYPE

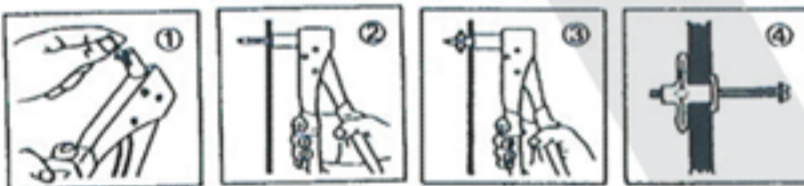

Item No.	Flange		Drill Hole Dia. (mm)	Plate Thickness (mm)	Packing (pcs)
	Dia. (mm)	Length (mm)			
001-43-AB4M	6	30	6.5	10	20/pack
001-43-AB4MB	6	30	6.5	10	200/box



AB-409-C

### NO. S 1-44 "HIT" STEEL BOARD ANCHOR HOOK TYPE



AB-409-L

Item No	Length (mm)	Board Thickness (mm)	Drill Hole Dia. (mm)	Packing (pcs/box)
001-44-AB409C	33	3-9	9	50
001-44-AB409L	33	3-9	9	50
001-44-AB409O	33	3-9	9	50



AB-409-O



**RHB-175 Bent Nose - Internal**



**RHS-175 Straight Nose - Internal**

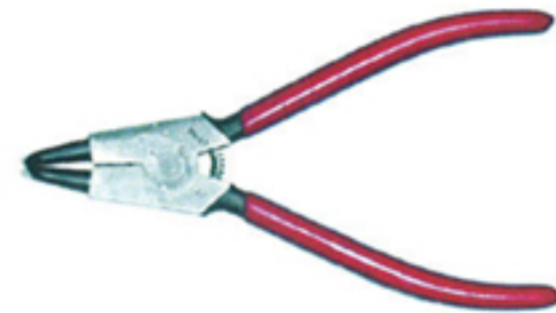

**RSB-175 Bent Nose - External**

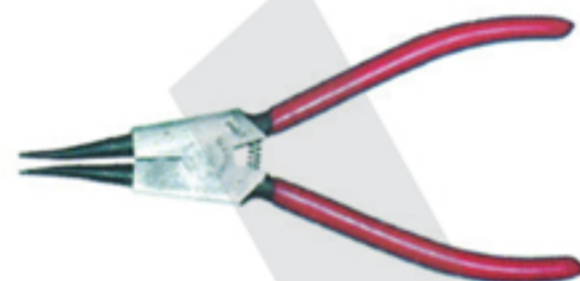

**RSS-175 Straight Nose - External**

**NO. S 1-30 "HIT" CIRCLIP PLIER**

Item No.	Length (mm)	Type	Capacity (mm)	Wt (g)	Packing (pcs/box)
001-30-RHB	165	Internal-Bent	12-65	150	6
001-30-RHS	175	Internal-Straight	12-65	150	6
001-30-RSB	165	External-Bent	10-40	150	6
001-30-RSS	175	External-Straight	10-40	150	6



**NO. S 1-32 "HIT" COMBINATION PLIER WITH WIRE STRIPPER AND TERMINAL PRESS INSULATED HANDLE**

Item No.	Length (mm)	Wt (g)	Packing (pcs/box)
001-32-MC175I	175	290	6
001-32-MC200I	200	380	6



**NO. S 1-33 "HIT" CABLE STRIPPING TOOLS**

Newly designed to strip vinyl cover, easily and safely than to use electrician knife.

Item No.	Cutting Capacity IV.HIV.FP CABLE	Packing (pcs/box)
001-33-F107	22-200mm <sup>2</sup>	6



**NO. S 1-34 "HIT" NAIL PULLER**

Item No.	Model	Length (mm)	Wt (g)	Packing (pcs/box)
001-34-NP450	NP-450	450 (18")	1650	5